



OLIVE HOMES

PORTUGAL PROPERTY

Property Ref

OH2507

Azeitona Lares - Soc Med Imob Lda
Edif. Al-Sakia, lote LHM10, R/C, EP12,
Fonte Santa, 8125-020,
Quarteira, Algarve, Portugal.
info@olivehomes.com
+351 289103471 +351 917474777
(Chamada para rede fixa nacional) (Chamada para rede móvel nacional)

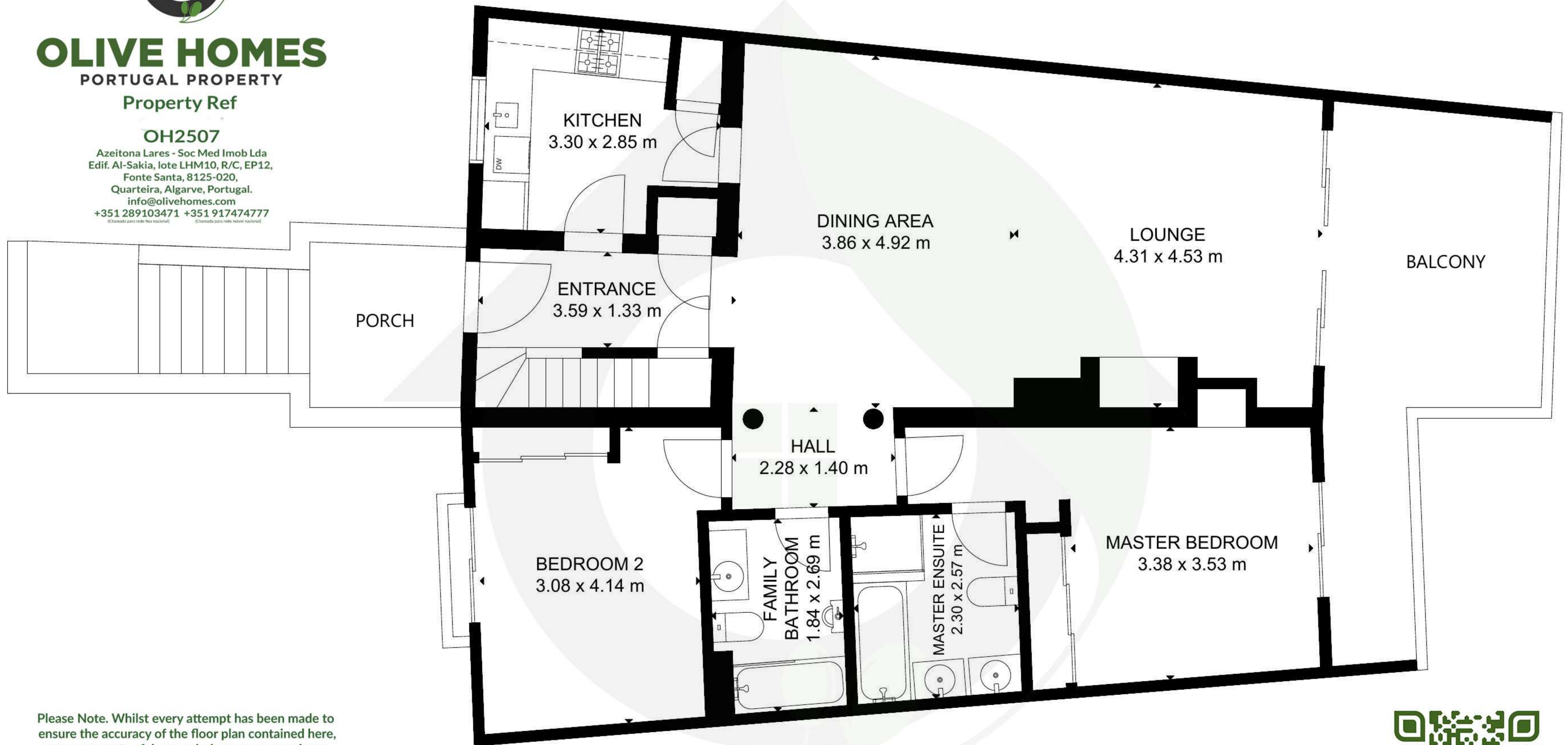

Please Note. Whilst every attempt has been made to ensure the accuracy of the floor plan contained here, measurements of doors, windows, rooms and any other items are approximate and no responsibility is taken for any error, omission, or misstatement.

This plan is for illustrative purposes only and should only be used as such by any prospective purchaser.

GROUND FLOOR

GROSS INTERNAL AREA
TOTAL: 105 m²
GROUND FLOOR: 105 m²

SIZE AND DIMENSIONS ARE APPROXIMATE, ACTUAL MAY VARY.



OLIVE HOMES
PORTUGAL PROPERTY



SITEPLAN



OLIVE HOMES

PORTUGAL PROPERTY

Property Ref

OH2507

Azeitona Lares - Soc Med Imob Lda
Edif. Al-Sakia, lote LHM10, R/C, EP12,
Fonte Santa, 8125-020,
Quarteira, Algarve, Portugal.

info@olivehomes.com
+351 289103471 +351 917474777
(Chamada para rede fixa nacional) (Chamada para rede móvel nacional)

Please Note. Whilst every attempt has been made to ensure the accuracy of the floor plan contained here, measurements of doors, windows, rooms and any other items are approximate and no responsibility is taken for any error, omission, or misstatement.

This plan is for illustrative purposes only and should only be used as such by any prospective purchaser.